

ISO Components

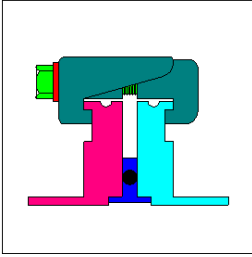

ISO INTRODUCTION



A

X-TRONIX Quality ISO flanges are manufactured from 316L (1.4404) stainless steel. There are four different configurations as shown.

- Figure A - illustrates the double claw-clamp assembly, most commonly used configuration.
- Figure B - shows the wall clamp assembly where a claw-clamp flange is mounted to a tapped bolt flange of a valve body for example.
- Figure C - the rotatable bolt ring shown in this assembly combines the claw-clamp and bolt flange with nuts and bolts. The rotatable bolt ring consists of a rotatable outer ring and a split retainer ring to hold the claw-clamp in place.
- Figure D - shows two bolted fixed flanges.

All four configurations use an O-ring seal held in place by a centering ring. This is effective down to 10^{-8} mbar. With Viton O-rings the assemblies are bakeable to 200°C (sustained 150°C).

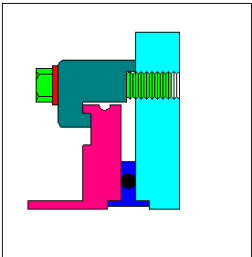

B

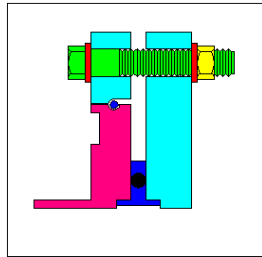

C

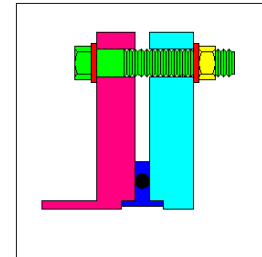

D

ISO DOUBLE CLAW CLAMPS - STEEL

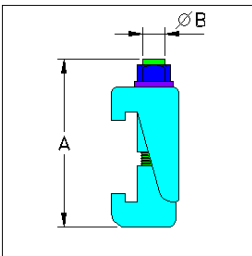

Part Number	Pneurop	A	B	C	D	No. Required Per Flange
XTR63/250-30-0495	NW63 to NW250	60	M10	-	-	4
XTR320/500-30-0496	NW320 to NW500	75	M12	-	-	8
XTR630-30-0497	NW63	85	M12	-	-	12

ISO DOUBLE CLAW CLAMPS - ALUMINIUM

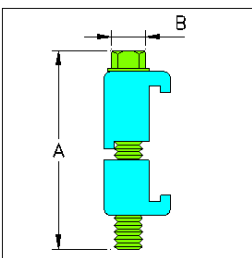

Part Number	Pneurop	A	B	C	D	No. Required Per Flange
XTR63/100-30-0498	NW63 to NW100	50	M10	-	-	4
XTR160/250-30-0499	NW160 to NW250	52	M10	-	-	4
XTR320/500-30-0500	NW320 to NW500	68	M12	-	-	8

ISO WALL CLAMPS - STEEL

Used with blind tapped holes and centering ring.

Part Number	Pneurop	A	B	C	D	E
XTR63/100-31-0501	NW63 to NW100	16.8	M8	29.3	-	-
XTR160/250-31-0502	NW160 to NW250	15.8	M10	32.8	-	-
XTR320/500-31-0503	NW320 to NW500	28.4	M12	41.9	-	-
XTR630-31-0504	NW630	33.4	M12	46.9	-	-

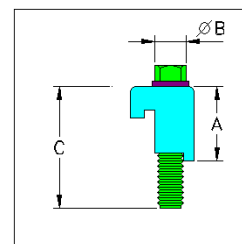

ISO WALL CLAMP, NUT & WASHER - STEEL

Used with blind tapped holes and centering ring.

Part Number	Pneurop	A	B	C	D	E
XTR63/100-31-0505	NW63 to NW100	16.8	M8	39.4	-	-
XTR160/250-31-0506	NW160 to NW250	15.8	M10	42.8	-	-
XTR320/500-31-0507	NW320 to NW500	28.4	M12	56.9	-	-

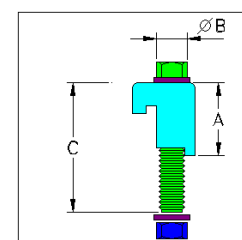

ISO WALL CLAMP - STEEL

Used with blind tapped holes and O-ring.

Part Number	Pneurop	A	B	C	D	E
XTR63/100-31-0508	NW63 to NW100	15.0	M8	29.3	-	-
XTR160/250-31-0509	NW160 to NW250	16.8	M10	32.8	-	-
XTR320/500-31-0510	NW320 to NW500	25.8	M12	46.9	-	-

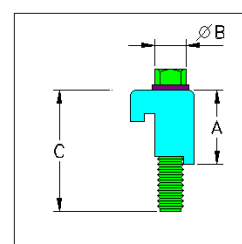

ISO WALL CLAMP, NUT & WASHER - ALUMINIUM

Used with blind tapped holes and centering ring.

Part Number	Pneurop	A	B	C	D	E
XTR63/100-31-0511	NW63 to NW100	16.8	M8	29.3	-	-
XTR160/250-31-0512	NW160 to NW250	15.8	M10	32.8	-	-
XTR320/500-31-0513	NW320 to NW500	28.4	M12	46.9	-	-

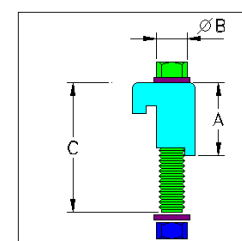

ISO WALL CLAMPS - ALUMINIUM

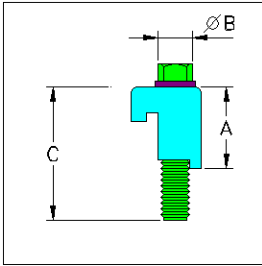

Used with tapped holes and centering ring

Part Number	Pneurop	A	B	C	D	E
XTR63/100-32-0514	NW63 to NW100	16.8	M8	29.3	-	-
XTR160/250-32-0515	NW160 to NW250	15.8	M10	32.8	-	-
XTR320/500-32-0516	NW320 to NW500	28.4	M12	46.9	-	-

ISO VITON® O-RINGS

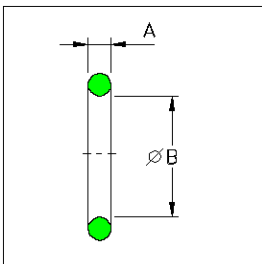

Maximum bakeout temperature 200°C. Sustained use 150°C.

Part Number	Pneurop	A	B	C	D	E
XTR63-32-0517	NW63	5.3	76	-	-	-
XTR80-32-0518	NW80	5.3	88	-	-	-
XTR100-32-0519	NW100	5.3	107	-	-	-
XTR160-32-0520	NW160	5.3	158	-	-	-
XTR200-32-0521	NW200	5.3	221	-	-	-
XTR250-32-0522	NW250	5.3	253	-	-	-
XTR320-32-0523	NW320	7	330	-	-	-
XTR400-32-0524	NW400	7	405	-	-	-
XTR500-32-0525	NW500	7	507	-	-	-
XTR630-32-0526	NW630	7	659	-	-	-

ISO NITRILE O-RINGS

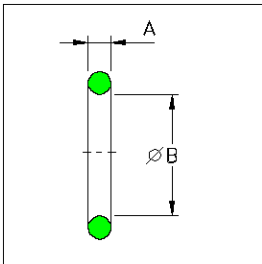

Maximum bakeout temperature 100°C

Part Number	Pneurop	A	B	C	D	E
XTR63-32-0527	NW63	5.3	76	-	-	-
XTR80-32-0528	NW80	5.3	88	-	-	-
XTR100-32-0529	NW100	5.3	107	-	-	-
XTR160-32-0530	NW160	5.3	158	-	-	-
XTR200-32-0531	NW200	5.3	221	-	-	-
XTR250-32-0532	NW250	5.3	253	-	-	-
XTR320-32-0533	NW320	7	330	-	-	-
XTR400-32-0534	NW400	7	405	-	-	-
XTR500-32-0535	NW500	7	507	-	-	-
XTR630-32-0536	NW630	7	659	-	-	-

ISO STAINLESS STEEL CENTERING RINGS, VITON® O-RING

Part Number	Pneurop	A	B	C	D	E
XTR40-33-0537	NW40	8	3.9	41	-	-
XTR63-33-0538	NW63	8	3.9	70	-	-
XTR80-33-0539	NW80	8	3.9	83	-	-
XTR100-33-0540	NW100	8	3.9	102	-	-
XTR160-33-0541	NW160	8	3.9	153	-	-
XTR200-33-0542	NW200	8	3.9	213	-	-
XTR250-33-0543	NW250	8	3.9	261	-	-
XTR320-33-0544	NW320	14	5.6	318	-	-
XTR400-33-0545	NW400	14	5.6	400	-	-
XTR500-33-0546	NW500	14	5.6	501	-	-
XTR630-33-0547	NW630	14	5.6	651	-	-

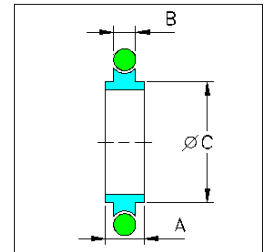

ISO ALUMINIUM CENTERING RINGS, VITON® O-RING

Part Number	Pneurop	A	B	C	D	E
XTR40-33-0548	NW40	8	3.9	41	-	-
XTR63-33-0549	NW63	8	3.9	70	-	-
XTR80-33-0550	NW80	8	3.9	83	-	-
XTR100-33-0551	NW100	8	3.9	102	-	-
XTR160-33-0552	NW160	8	3.9	153	-	-
XTR200-33-0553	NW200	8	3.9	213	-	-
XTR250-33-0554	NW250	8	3.9	261	-	-
XTR320-33-0555	NW320	14	5.6	318	-	-
XTR400-33-0556	NW400	14	5.6	400	-	-
XTR500-33-0557	NW500	14	5.6	501	-	-
XTR630-33-0558	NW630	14	5.6	651	-	-

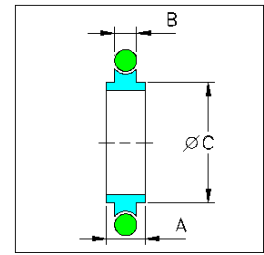

ISO STAINLESS STEEL CENTERING RINGS, NITRILE O-RING

Part Number	Pneurop	A	B	C	D	E
XTR40-33-0559	NW40	8	3.9	41	-	-
XTR63-33-0560	NW63	8	3.9	70	-	-
XTR80-33-0561	NW80	8	3.9	83	-	-
XTR100-33-0562	NW100	8	3.9	102	-	-
XTR160-33-0563	NW160	8	3.9	153	-	-
XTR200-33-0564	NW200	8	3.9	213	-	-
XTR250-33-0565	NW250	8	3.9	261	-	-
XTR320-33-0566	NW320	14	5.6	318	-	-
XTR400-33-0567	NW400	14	5.6	400	-	-
XTR500-33-0568	NW500	14	5.6	501	-	-
XTR630-33-0569	NW630	14	5.6	651	-	-

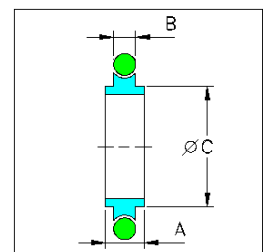

ISO ALUMINIUM CENTERING RINGS, NITRILE O-RING

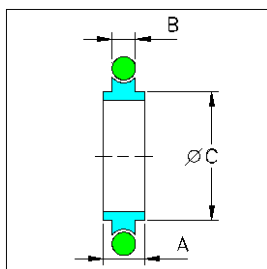

Part Number	Pneurop	A	B	C	D	E
XTR40-34-0570	NW40	8	3.9	41	-	-
XTR63-34-0571	NW63	8	3.9	70	-	-
XTR80-34-0572	NW80	8	3.9	83	-	-
XTR100-34-0573	NW100	8	3.9	102	-	-
XTR160-34-0574	NW160	8	3.9	153	-	-
XTR200-34-0575	NW200	8	3.9	213	-	-
XTR250-34-0576	NW250	8	3.9	261	-	-
XTR320-34-0577	NW320	14	5.6	318	-	-
XTR400-34-0578	NW400	14	5.6	400	-	-
XTR500-34-0579	NW500	14	5.6	501	-	-
XTR630-34-0580	NW630	14	5.6	651	-	-

ISO ST. ST. TRAPPED CENTERING RINGS, VITON® O-RING

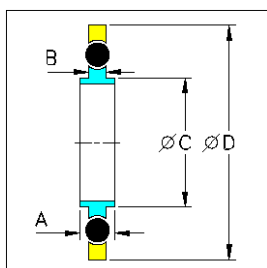

Part Number	Pneurop	A	B	C	D	E
XTR40-34-0581	NW40	8	3.9	41	63	-
XTR63-34-0582	NW63	8	3.9	70	94	-
XTR80-34-0583	NW80	8	3.9	83	109	-
XTR100-34-0584	NW100	8	3.9	102	128	-
XTR160-34-0585	NW160	8	3.9	153	179	-
XTR200-34-0586	NW200	8	3.9	213	239	-
XTR250-34-0587	NW250	8	3.9	261	287	-
XTR320-34-0588	NW320	14	5.6	318	358	-
XTR400-34-0589	NW400	14	5.6	400	440	-
XTR500-34-0590	NW500	14	5.6	501	541	-
XTR630-34-0591	NW630	14	5.6	651	691	-

ISO ALUMINIUM TRAPPED CENTERING RINGS, VITON® O-RING

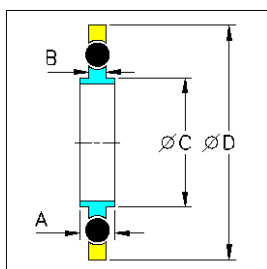

Part Number	Pneurop	A	B	C	D	E
XTR40-34-0592	NW40	8	3.9	41	63	-
XTR63-34-0593	NW63	8	3.9	70	94	-
XTR80-34-0594	NW80	8	3.9	83	109	-
XTR100-34-0595	NW100	8	3.9	102	128	-
XTR160-34-0596	NW160	8	3.9	153	179	-
XTR200-34-0597	NW200	8	3.9	213	239	-
XTR250-34-0598	NW250	8	3.9	261	287	-
XTR320-34-0599	NW320	14	5.6	318	358	-
XTR400-34-0600	NW400	14	5.6	400	440	-
XTR500-34-0601	NW500	14	5.6	501	541	-
XTR630-34-0602	NW630	14	5.6	651	691	-

ISO MESH CENTERING RINGS, VITON® O-RING

Part Number	Pneurop	A	B	C	D	E
XTR63-35-0603	NW63	8	3.9	70	-	-
XTR80-35-0604	NW80	8	3.9	83	-	-
XTR100-35-0605	NW100	8	3.9	102	-	-
XTR160-35-0606	NW160	8	3.9	153	-	-

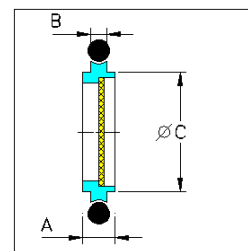

ISO ST. ST. TRAPPED CENTERING RINGS, NITRILE O-RING

Part Number	Pneurop	A	B	C	D	E
XTR40-35-0607	NW40	8	3.9	41	63	-
XTR63-35-0608	NW63	8	3.9	70	94	-
XTR80-35-0609	NW80	8	3.9	83	109	-
XTR100-35-0610	NW100	8	3.9	102	128	-
XTR160-35-0611	NW160	8	3.9	153	179	-
XTR200-35-0612	NW200	8	3.9	213	239	-
XTR250-35-0613	NW250	8	3.9	261	287	-
XTR320-35-0614	NW320	14	5.6	318	358	-
XTR400-35-0615	NW400	14	5.6	400	440	-
XTR500-35-0616	NW500	14	5.6	501	541	-
XTR630-35-0617	NW630	14	5.6	651	691	-

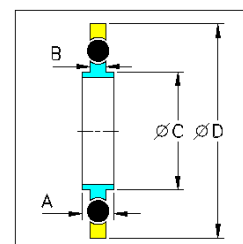

Note: Aluminium outer

ISO ALUMINIUM TRAPPED CENTERING RINGS, NITRILE O-RING

Part Number	Pneurop	A	B	C	D	E
XTR40-35-0618	NW40	8	3.9	41	63	-
XTR63-35-0619	NW63	8	3.9	70	94	-
XTR80-35-0620	NW80	8	3.9	83	109	-
XTR100-35-0621	NW100	8	3.9	102	128	-
XTR160-35-0622	NW160	8	3.9	153	179	-
XTR200-35-0623	NW200	8	3.9	213	239	-
XTR250-35-0624	NW250	8	3.9	261	287	-
XTR320-35-0625	NW320	14	5.6	318	358	-
XTR400-35-0626	NW400	14	5.6	400	440	-
XTR500-35-0627	NW500	14	5.6	501	541	-
XTR630-35-0628	NW630	14	5.6	651	691	-

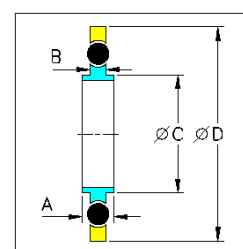

ISO MESH CENTERING RING, NITRILE O-RING

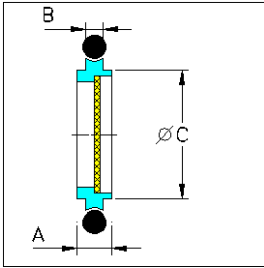

Stainless steel centering ring with mesh screen and replaceable Nitrile O-ring

Part Number	Pneurop	A	B	C	D	E
XTR63-36-0629	NW63	8	3.9	70	-	-
XTR80-36-0630	NW80	8	3.9	83	-	-
XTR100-36-0631	NW100	8	3.9	102	-	-
XTR160-36-0632	NW160	8	3.9	153	-	-

ISO NUT, BOLT & WASHERS SETS FOR 2 BOLTED FLANGES

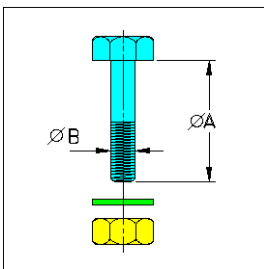

Part Number	Pneurop	A	B	C	D	Pack Qty.
XTR63-36-0633	NW63	40	M8	-	-	4
XTR100-36-0634	NW80 to NW100	40	M8	-	-	8
XTR160-36-0635	NW160	50	M10	-	-	8
XTR200-36-0636	NW200 to NW250	50	M10	-	-	12

Silver plated bolts available on request

ISO BOLT & WASHER SETS

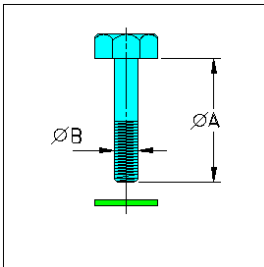

For joining bolted flanges to tapped flanges

Part Number	Pneurop	A	B	C	D	Pack Qty.
XTR63-36-0637	NW63	30	M8	-	-	4
XTR100-36-0638	NW80 to NW100	30	M8	-	-	8
XTR160-36-0639	NW160	35	M10	-	-	8
XTR200-36-0640	NW200 to NW250	35	M10	-	-	12

Silver plated bolts available on request

ISO FIXED BOLTED BLANK FLANGE – STAINLESS STEEL

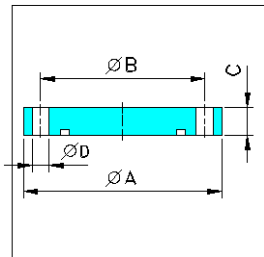

Part Number	Pneurop	A	B	C	D x No.	E
XTR63-36-0641	NW63	130	110	12	9 x 4	-
XTR80-36-0642	NW80	145	125	12	9 x 8	-
XTR100-36-0643	NW100	165	145	12	9 x 8	-
XTR160-36-0644	NW160	225	200	16	11 x 8	-
XTR200-36-0645	NW200	285	260	16	11 x 12	-
XTR250-36-0646	NW250	335	310	16	11 x 12	-
XTR320-36-0647	NW320	425	395	20	14 x 12	-
XTR400-36-0648	NW400	510	480	20	14 x 16	-

ISO FIXED BOLTED BORED FLANGES – STAINLESS STEEL

Note: dimensions A, B, C & D are same as the previous blank flange

Part Number	Pneurop	E	F
XTR63-37-0649	NW63	70	76
XTR80-37-0650	NW80	83	89
XTR100-37-0651	NW100	102	108
XTR160-37-0652	NW160	153	159
XTR200-37-0653	NW200	213	219
XTR250-37-0654	NW250	261	267

Note: F is tube diameter

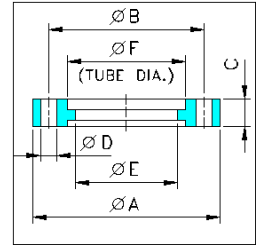

ISO FIXED BOLTED TUBULATIONS – STAINLESS STEEL

Note: dimensions A, B, C & D are same as the ISO fixed bolted blank flanges

Part Number	Pneurop	E	F*	G
XTR63-37-0655	NW63	70	76	100
XTR80-37-0656	NW80	83	89	100
XTR100-37-0657	NW100	102	108	100
XTR160-37-0658	NW160	153	159	100
XTR200-37-0659	NW200	213	219	100

Special lengths available on request.

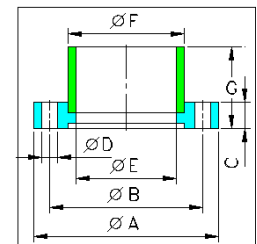

ISO ROTATABLE BOLT RINGS - STEEL

As shown in Figure C of our ISO introduction (page 30) these steel rings fit over the standard claw clamp flanges to convert them to rotatable bolted flanges. Retaining ring is included.

Part Number	Pneurop	A	B	C	D	E x No.
XTR63-37-0660	NW63	130	110	12	95.5	9 x 4
XTR80-37-0661	NW80	145	125	12	110	9 x 8
XTR100-37-0662	NW100	165	145	12	130.5	9 x 8
XTR160-37-0663	NW160	225	200	16	180.7	11 x 8
XTR200-37-0664	NW200	285	260	16	240.7	11 x 12
XTR250-37-0665	NW250	335	310	16	290.7	11 x 12
XTR320-37-0666	NW320	425	395	20	371	14 x 12
XTR400-37-0667	NW400	510	480	20	451	14 x 16

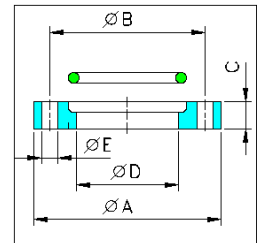

*Typical, varies with tube availability.

ISO REPLACEMENT RETAINING RINGS

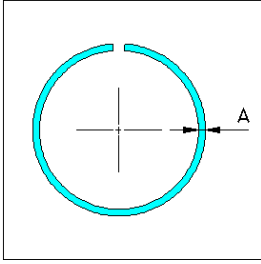

For rotatable bolt rings (page 37)

Part Number	ISO / KF	To Fit Ring
XTR63-38-0668	3	ISO63R
XTR80-38-0669	3	ISO80R
XTR100-38-0670	3	ISO100R
XTR160-38-0671	5	ISO160R
XTR200-38-0672	5	ISO200R
XTR250-38-0673	5	ISO250R
XTR320-38-0674	5	ISO320R
XTR400-38-0675	8	ISO400R

ISO BLANK CLAW FLANGES – STAINLESS STEEL

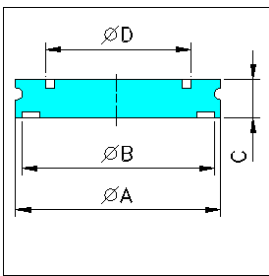

Part Number	Pneurop	A	B	C	D	E
XTR63-38-0676	NW63	95	90	12	70	-
XTR80-38-0677	NW80	110	105	12	83	-
XTR100-38-0678	NW100	130	125	12	102	-
XTR160-38-0679	NW160	180	175	12	153	-
XTR200-38-0680	NW200	240	235	12	213	-
XTR250-38-0681	NW250	290	285	12	261	-
XTR320-38-0682	NW320	370	365	17	318	-
XTR400-38-0683	NW400	450	445	17	400	-
XTR500-38-0684	NW500	550	545	17	501	-
XTR630-38-0685	NW630	690	685	22	651	-

ISO BORED CLAW FLANGES – STAINLESS STEEL

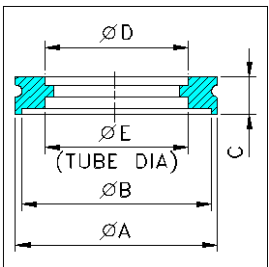

Part Number	Pneurop	A	B	C	D	E
XTR63-38-0686	NW63	95	90	12	70	76
XTR80-38-0687	NW80	110	105	12	83	89
XTR100-38-0688	NW100	130	125	12	102	108
XTR160-38-0689	NW160	180	175	12	153	159
XTR200-38-0690	NW200	240	235	12	213	219
XTR250-38-0691	NW250	290	285	12	261	267
XTR320-38-0692	NW320	370	365	17	318	324
XTR400-38-0693	NW400	450	445	17	400	406
XTR500-38-0694	NW500	550	545	17	501	508

ISO CLAW CLAMP TUBULATIONS (HALF NIPPLES) – ST. ST.

Part Number	Pneurop	A	B*	C	D	E
XTR63-39-0695	NW63	95	70	100	-	-
XTR80-39-0696	NW80	110	83	100	-	-
XTR100-39-0697	NW100	130	102	100	-	-
XTR160-39-0698	NW160	180	153	100	-	-
XTR200-39-0699	NW200	240	213	100	-	-
XTR250-39-0700	NW250	290	261	100	-	-
XTR320-39-0701	NW320	370	318	100	-	-
XTR400-39-0702	NW400	450	400	100	-	-
XTR500-39-0703	NW500	550	501	100	-	-

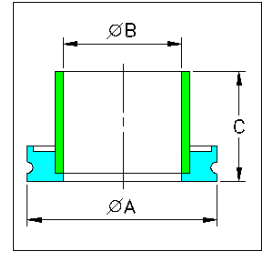

Special lengths available on request.

ISO STRAIGHT CONNECTORS (FULL NIPPLES) – ST. ST.

Part Number	Pneurop	A	B*	C	D	E
XTR63-39-0704	NW63	95	70	100	-	-
XTR80-39-0705	NW80	110	83	100	-	-
XTR100-39-0706	NW100	130	102	100	-	-
XTR160-39-0707	NW160	180	153	100	-	-
XTR200-39-0708	NW200	240	213	100	-	-
XTR250-39-0709	NW250	290	261	100	-	-

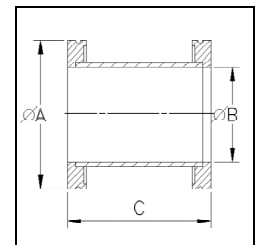

Special lengths available on request.

ISO STRAIGHT CONNECTORS WITH KF LATERAL PORTS – ST.ST.

ISO stainless steel straight connectors with one KF16 and one KF40 lateral ports

Part Number	Pneurop	A	B (KF16)	B (KF40)	C
XTR63-39-0710	NW63/40/16	95	60	80	88
XTR100-39-0711	NW100/40/16	130	75	75	108
XTR160-39-0712	NW160/40/16	180	100	100	138

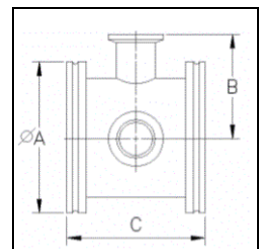

*Typical, varies with tube availability.

CF TO ISO TUBULATED ADAPTORS

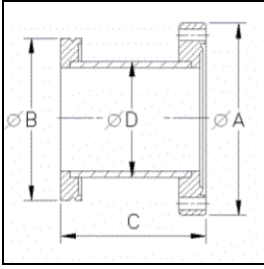

Part Number	CF / ISO	Material	A	B	C	D*
XTR6363-40-0713	NW63CF/ISO63	304L / 316L	114	95	90	70
XTR1063-40-0714	NW100CF/ISO63	304L / 316L	152	95	90	76
XTR1010-40-0715	NW100CF/ISO100	304L / 316L	152	130	90	102
XTR1016-40-0716	NW100CF/ISO160	304L / 316L	152	180	90	102
XTR1510-40-0717	NW150CF/ISO100	304L / 316L	203	130	90	108
XTR1516-40-0718	NW150CF/ISO160	304L / 316L	203	180	90	152

Special lengths available on request

ISO TUBULATED REDUCING ADAPTORS – STAINLESS STEEL

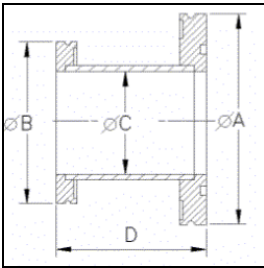

Part Number	Pneurop	A	B	C*	D
XTR80-40-0719	NW80/63	110	95	70	50
XTR100-40-0720	NW100/63	130	95	70	50
XTR160-40-0721	NW160/63	180	95	70	50
XTR200-40-0722	NW200/63	240	95	70	90
XTR100-40-0723	NW100/80	130	110	83	50
XTR160-40-0724	NW160/80	180	110	83	50
XTR160-40-0725	NW160/100	180	130	102	50
XTR200-40-0726	NW200/100	240	130	102	90
XTR200-40-0727	NW200/160	240	180	153	90
XTR250-40-0728	NW250/160	290	180	153	90
XTR250-40-0729	NW250/200	290	240	213	90

Special lengths available on request

ISO TO KF TUBULATED ADAPTORS – STAINLESS STEEL

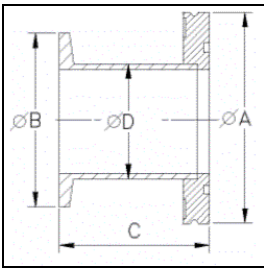

Part Number	ISO / KF	A	B	C	D*
XTR6325-40-0730	ISO63/KF25	95	40	50	28
XTR6340-40-0731	ISO63/KF40	95	55	50	45
XTR1040-40-0732	ISO100/KF40	130	55	50	45
XTR6350-40-0733	ISO63/KF50	95	75	50	57
XTR6325-40-0734	ISO100/KF50	130	75	50	57

*Typical, varies with tube availability.

ISO40 BOLTED TO KF50 ADAPTOR – STAINLESS STEEL

Part Number	A	B*	C	D	E
XTR4050-41-0735	50	41	100	75	-

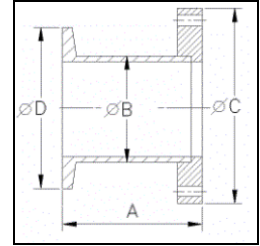

ISO TO ASA TUBULATED ADAPTORS – STAINLESS STEEL

Without O-ring groove. ASA flanges with O-ring grooves available on request (add suffix 'G' to Part Number)

Part Number	A	B*	C	Flanges
XTR632-41-0736	106	70	152	ISO63 / ASA 2"
XTR802-41-0737	106	76	152	ISO80 / ASA 2"
XTR1002-41-0738	106	76	152	ISO100 / ASA 2"
XTR633-41-0739	106	70	190	ISO63 / ASA 3"
XTR803-41-0740	106	70	190	ISO80 / ASA 3"
XTR1003-41-0741	106	102	190	ISO100 / ASA 3"
XTR1004-41-0742	106	102	299	ISO100 / ASA 4"
XTR1604-41-0743	106	153	299	ISO160 / ASA 4"
XTR1606-41-0744	112	153	279	ISO160 / ASA 6"
XTR2006-41-0745	112	197	279	ISO200 / ASA 6"

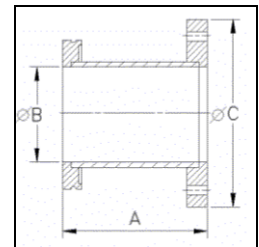

ISO 45° BENDS - STAINLESS STEEL

Part Number	Pneuop	A	B*	C	D	E
XTR63-41-0746	NW63	95	76	82	-	-
XTR100-41-0747	NW100	130	108	128	-	-

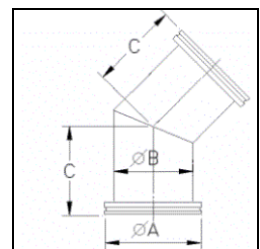

*Typical, varies with tube availability.

ISO ELBOWS – STAINLESS STEEL

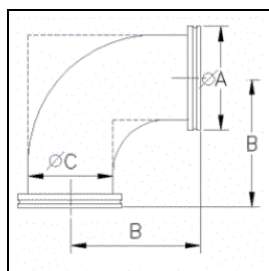

Part Number	Pneurop	A	B	C	D	Style
XTR63-42-0748	NW63	95	88	70	-	Swept
XTR80-42-0749	NW80	110	98	70	-	Swept
XTR100-42-0750	NW100	130	108	108	-	Swept
XTR160-42-0751	NW160	180	138	159	-	Mitred
XTR200-42-0752	NW200	240	178	219	-	Mitred
XTR250-42-0753	NW250	290	208	267	-	Mitred

ISO TEES – STAINLESS STEEL

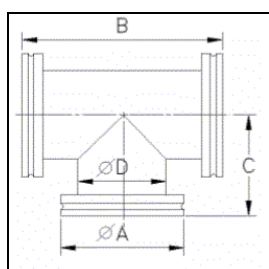

Part Number	Pneurop	A	B	C	D*	E
XTR63-42-0754	NW63	95	176	88	76	-
XTR80-42-0755	NW80	110	196	98	89	-
XTR100-42-0756	NW100	130	216	108	108	-
XTR160-42-0757	NW160	180	276	138	159	-
XTR200-42-0758	NW200	240	356	178	219	-
XTR250-42-0759	NW250	290	416	208	267	-

ISO UNEQUAL TEES – STAINLESS STEEL

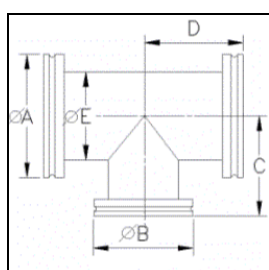

Part Number	Pneurop	A	B	C	D	E*
XTR100-42-0760	NW100/63	130	95	107	108	108
XTR160-42-0761	NW160/63	180	95	130	138	159
XTR160-42-0762	NW160/100	180	130	131	138	159

ISO TO KF REDUCING TEES – STAINLESS STEEL

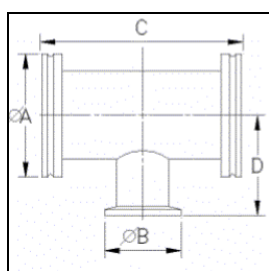

Part Number	ISO / KF	A	B	C	D	E
XTR63-42-0763	63 / 16	95	30	204	58	-
XTR63-42-0764	63 / 25	95	40	204	79	-
XTR63-42-0765	63 / 40	95	55	204	76	-
XTR100-42-0766	100 / 25	130	40	260	98	-
XTR100-42-0767	100 / 40	130	55	260	95	-

Typical varies with tube availability

ISO 4-WAY CROSSES – STAINLESS STEEL

Part Number	Pneurop	A	B	C	D*	E
XTR63-43-0768	NW63	95	176	88	76	-
XTR80-43-0769	NW80	110	196	98	89	-
XTR100-43-0770	NW100	130	216	108	108	-
XTR160-43-0771	NW160	180	276	138	159	-
XTR200-43-0772	NW200	240	356	178	219	-
XTR250-43-0773	NW250	290	416	208	267	-

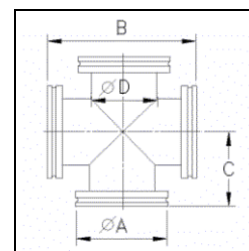

ISO UNEQUAL 4-WAY CROSSES – STAINLESS STEEL

Part Number	Pneurop	A	B	C	D	E*
XTR100-43-0774	NW100/63	130	95	107	108	108
XTR160-43-0775	NW160/63	180	95	130	138	159
XTR160-43-0776	NW160/100	180	130	131	138	159
XTR200-43-0777	NW200/160	240	180	168	178	219

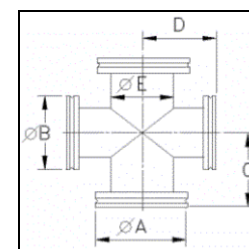

ISO TO KF REDUCING CROSSES - STAINLESS STEEL

Part Number	ISO / KF	A	B	C	D	E
XTR63-43-0778	63 / 16	95	30	102	58	-
XTR63-43-0779	63 / 25	95	40	102	79	-
XTR63-43-0780	63 / 40	95	55	102	76	-
XTR63-43-0781	63 / 50	95	75	102	92	-
XTR100-43-0782	100 / 25	130	40	130	98	-
XTR100-43-0783	100 / 40	130	55	130	95	-
XTR100-43-0784	100 / 50	130	75	130	111	-
XTR160-43-0785	160 / 40	180	55	160	121	-
XTR160-43-0786	160 / 50	180	75	160	136	-

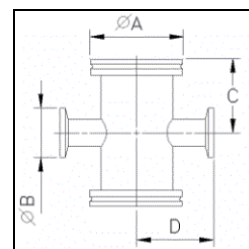

ISO 5-WAY CROSSES – STAINLESS STEEL

Part Number	Pneurop	A	B	C	D*	E
XTR100-43-0787	NW100	130	216	108	108	-
XTR160-43-0788	NW160	180	276	138	159	-

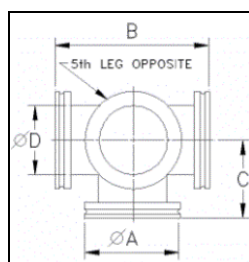

Typical, varies with tube availability.

ISO 6-WAY CROSSES –STAINLESS STEEL

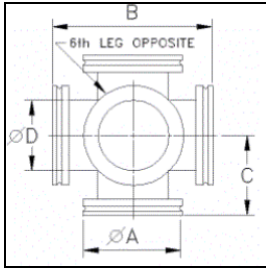

Part Number	Pneurop	A	B	C	D*	E
XTR63-44-0789	NW63	95	176	88	76	-
XTR80-44-0790	NW180	110	196	98	89	-
XTR100-44-0791	NW100	130	216	108	108	-
XTR160-44-0792	NW160	180	276	138	159	-
XTR200-44-0793	NW200	240	356	178	219	-
XTR250-44-0794	NW250	290	416	208	267	-

ISO FLEXIBLE HOSES

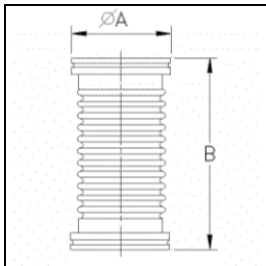

Used to overcome misalignment.

Part Number	Pneurop	A	B	C	D	E
XTR63-44-0795	NW63	95	250	-	-	-
XTR63-44-0796	NW63	95	500	-	-	-
XTR63-44-0797	NW63	95	750	-	-	-
XTR63-44-0798	NW63	95	1000	-	-	-
XTR80-44-0799	NW80	110	250	-	-	-
XTR80-44-0800	NW80	110	500	-	-	-
XTR80-44-0801	NW80	110	750	-	-	-
XTR80-44-0802	NW80	110	1000	-	-	-
XTR100-44-0803	NW100	130	250	-	-	-
XTR100-44-0804	NW100	130	500	-	-	-
XTR100-44-0805	NW100	130	750	-	-	-
XTR100-44-0806	NW100	130	1000	-	-	-
XTR160-44-0807	NW160	180	250	-	-	-
XTR160-44-0808	NW160	180	500	-	-	-
XTR160-44-0809	NW160	180	750	-	-	-
XTR160-44-0810	NW160	180	1000	-	-	-

ISO HYDROFORMED BELLOWS CONNECTORS

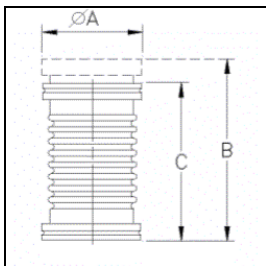

Used for straight connection between components to minimize the transfer of vibration.

Part Number	Pneurop	A	B	C	D	E
XTR63-44-0811	NW63	95	127	106	-	-
XTR80-44-0812	NW80	110	127	106	-	-
XTR100-44-0813	NW100	130	127	107	-	-
XTR160-44-0814	NW160	180	220	170	-	-
XTR200-44-0815	NW200	240	220	170	-	-
XTR250-44-0816	NW250	290	220	170	-	-

Typical, varies with tube availability.

ISO ZERO LENGTH KODIAL VIEWPORT

Part Number	Pneurop	A	B	C	D	E
XTR100-45-0817	NW100	8	3.9	102	-	-
XTR160-45-0818	NW160	8	3.9	153	-	-
XTR200-45-0819	NW200	8	3.9	213	-	-
XTR250-45-0820	NW250	8	3.9	261	-	-

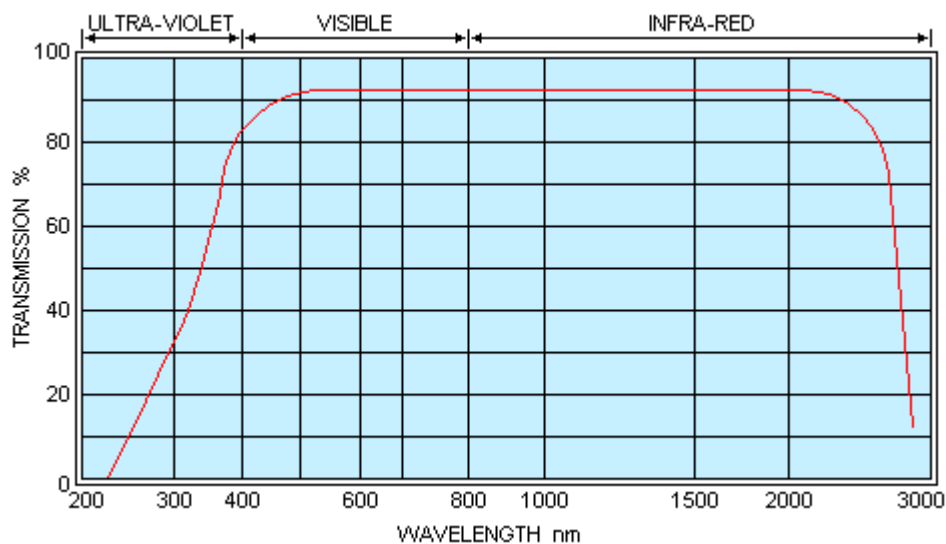
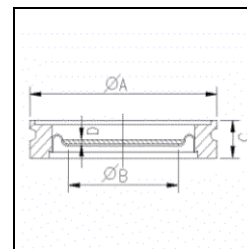

Kodial transmission curve

ISO POWER FEEDTHROUGHS

The range of power feedthroughs have stainless steel connectors of 40 amp, 15kV rating. Bakeable to 200°C.

Part Number	Pneurop	A	B	C	D	Connectors
XTR63-45-0821	NW63	95	65	73	M5	1
XTR63-45-0822	NW63	95	65	73	M5	4
XTR100-45-0823	NW100	130	65	73	M5	4

Larger flange sizes available on request.

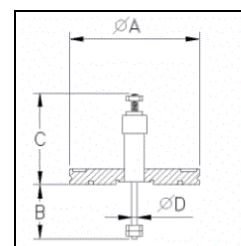

Rectangular Sputter Magnetron